

Overton Ridge Park:

Overton Ridge is an important park contributing much needed parkland space for the northern portions of the city. This park has an existing north-south oriented section featuring a shelter, basketball court, playscape, and concrete city trails. The addition of the 12 acre site is a dramatic addition to the park offering a completely different experience for park and trail users.

The existing park has a very open landscape so that frisbee, ball throwing, or other activities can be accommodated. The newer section is a more peaceful wooded space with the proposed terrace located on a high point overlooking the city to the northwest. The site has several existing features that will provide an opportunity to supply a natural setting for bird watchers and strollers; a small informal hill-top terrace and children's adventure play area, a barn that may be repurposed for an open air pavilion, and an open field for soccer practice.

This park is unique in that it bridges new Keller with old Keller and creates critical social and trail linkages. This mostly wooded site adds a critical segment to the city-wide trail system by connecting the Indian Trail to Roanoke Road thereby being one step closer to connecting the Northeast Park. Connecting parks is not as critical as connecting the system of trails so that joggers and bikers have paths that either take them to destinations or provides loops for exercise and touring.

Park Element Restrictions:

The regulations regarding the airplane landing strip to the north may not allow a variety of elements in the park that is along the flight path. Trees and other elements need to be approved prior to the continued discussion and planning of this park. The boundaries of these restrictions need to be defined prior to any improvements to this section of the park.

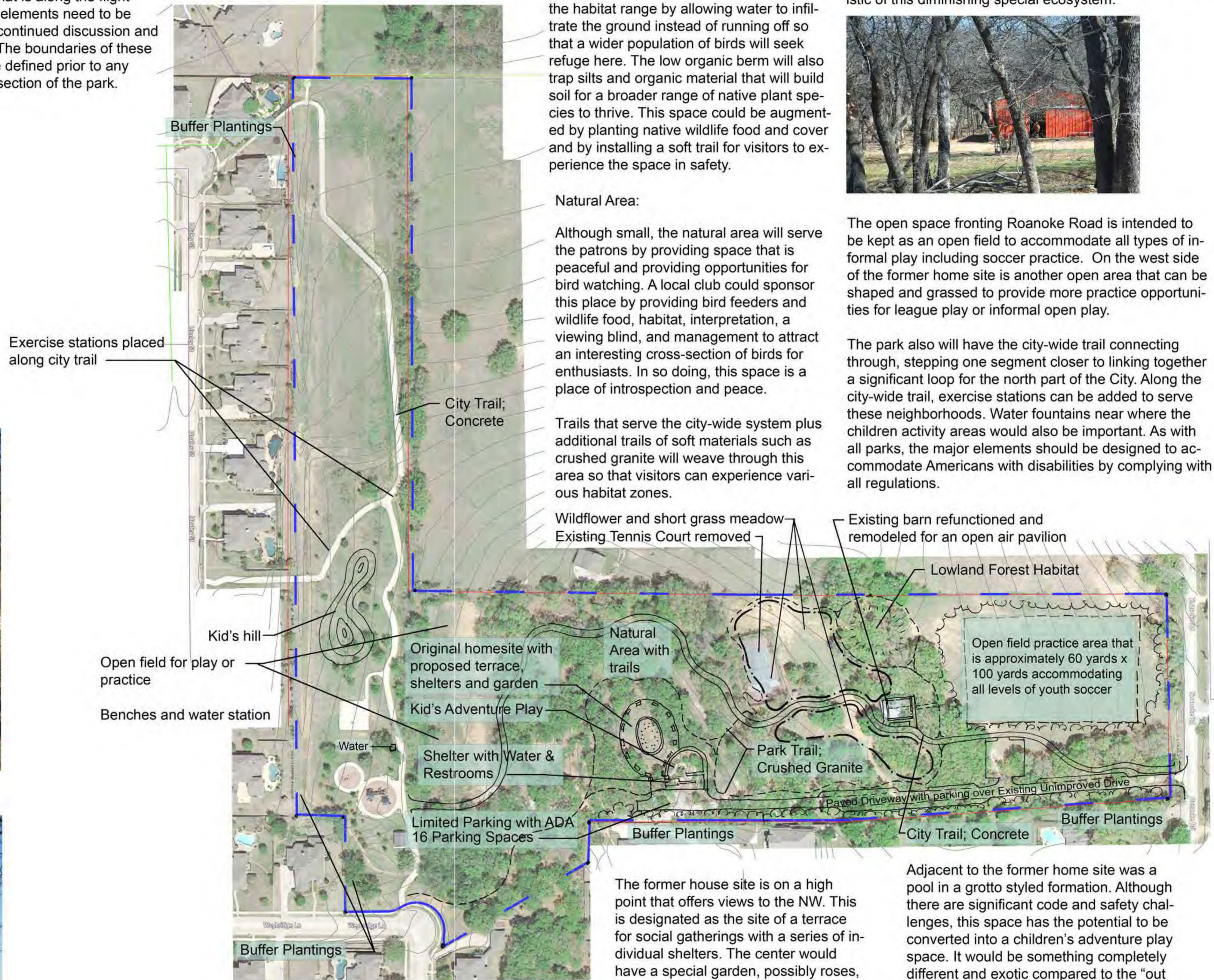

North of the existing barn is a low drainage-way that directs storm water to the adjacent property. A low berm of deadwood and organic materials that could impound water temporarily at very low levels creating a more lowland and moist habitat is proposed. The addition of this feature broadens the habitat range by allowing water to infiltrate the ground instead of running off so that a wider population of birds will seek refuge here. The low organic berm will also trap silts and organic material that will build soil for a broader range of native plant species to thrive. This space could be augmented by planting native wildlife food and cover and by installing a soft trail for visitors to experience the space in safety.

Cross Timbers Ecosystem:

The Overton Ridge forested section is a predominantly post oak forest. Having a park with these trees is a wonderful opportunity to interpret and educate the public on the importance of the Cross Timbers Ecosystem. This site is characteristic of this diminishing special ecosystem.



The open space fronting Roanoke Road is intended to be kept as an open field to accommodate all types of informal play including soccer practice. On the west side of the former home site is another open area that can be shaped and grassed to provide more practice opportunities for league play or informal open play.

The park also will have the city-wide trail connecting through, stepping one segment closer to linking together a significant loop for the north part of the City. Along the city-wide trail, exercise stations can be added to serve these neighborhoods. Water fountains near where the children activity areas would also be important. As with all parks, the major elements should be designed to accommodate Americans with disabilities by complying with all regulations.

Natural Area:

Although small, the natural area will serve the patrons by providing space that is peaceful and providing opportunities for bird watching. A local club could sponsor this place by providing bird feeders and wildlife food, habitat, interpretation, a viewing blind, and management to attract an interesting cross-section of birds for enthusiasts. In so doing, this space is a place of introspection and peace.

Trails that serve the city-wide system plus additional trails of soft materials such as crushed granite will weave through this area so that visitors can experience various habitat zones.

Wildflower and short grass meadow
Existing Tennis Court removed

Existing barn refunctioned and remodeled for an open air pavilion

Lowland Forest Habitat

Open field practice area that is approximately 60 yards x 100 yards accommodating all levels of youth soccer

The former house site is on a high point that offers views to the NW. This is designated as the site of a terrace for social gatherings with a series of individual shelters. The center would have a special garden, possibly roses, possibly commemorative. This garden space should be the project of an organization that can take special care of the elements within. The look and feel of the place is to remain somewhat rustic and without refinement. It is intended to be in harmony with the natural surroundings.

Adjacent to the former home site was a pool in a grotto styled formation. Although there are significant code and safety challenges, this space has the potential to be converted into a children's adventure play space. It would be something completely different and exotic compared to the "out of a box" playscapes and would animate and enliven the imagination of children. The surfaces may be in sand or other safe materials, slides transitioning levels installed, appropriate guard rails positioned; adventure around every corner.

Kid's Hill:
It is important to allow kids to use their own imagination when it comes to play. Providing a hill for kids to play on is an age-old attraction for spontaneous and self-organizing play allowing kids to form their own games. As simple and low cost as this may be, it very well could become a very popular space.